

19:1 - 517:1 ratio // 225.0 Nm

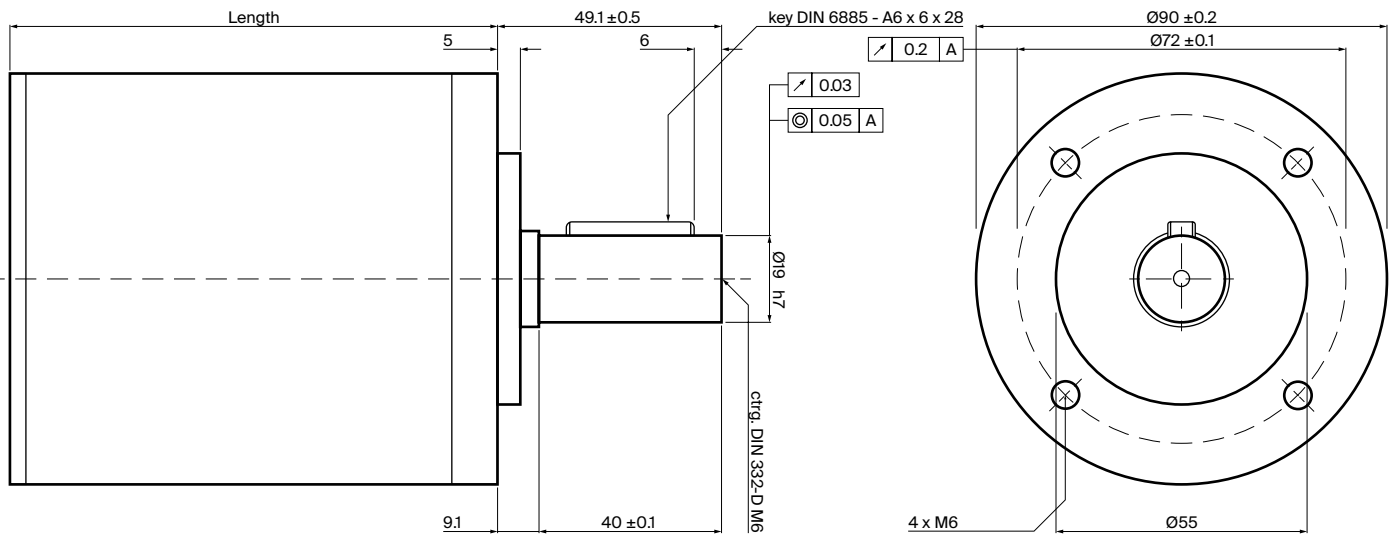

Part number key

Modular	#####
Standard	#####
Special	#####

Technical data

		90-19	90-77	90-98	90-294	90-403	90-517
1 Part number							
2 Gear ratio	.1	19	77	98	294	403	517
3 Stages		2	3	3	4	4	4
4 Max. continuous torque (S1) ¹	Nm	100.0	150.0	150.0	150.0	150.0	150.0
5 Max. intermittent torque	Nm	150.0	225.0	225.0	225.0	225.0	225.0
6 Efficiency	%	81	73	73	66	66	66
7 Backlash	arc.min	42	45	45	45	45	45
8 Max. axial load (dynamic)	N	120	200	200	200	200	200
9 Max. radial load, 12 mm from flange	N	600	1000	1000	1000	1000	1000
10 Weight	kg	2.2	2.8	2.8	3.4	3.4	3.4
11 Gear material ²		C / S	C / S	C / S	C / S	C / S	C / S
12 Length	mm	73.8	90.3	90.3	106.8	106.8	106.8

¹ S1 duty cycle based on 3000 RPM input speed ² Gear material: C = Composite, S = Steel

Modular system

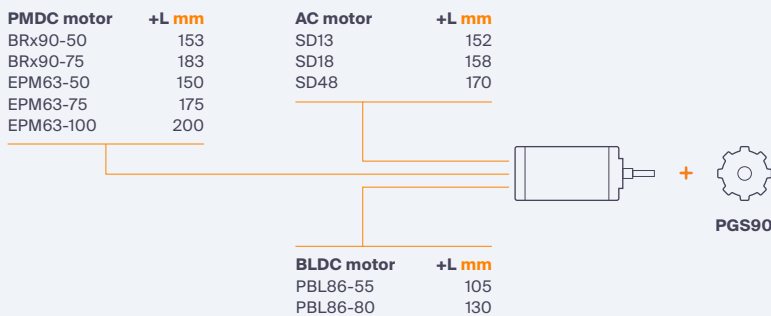

+L mm = added length