

GB9 Right-angle gearbox // Composite gears

12.5:1 - 75:1 ratio // 80 Nm

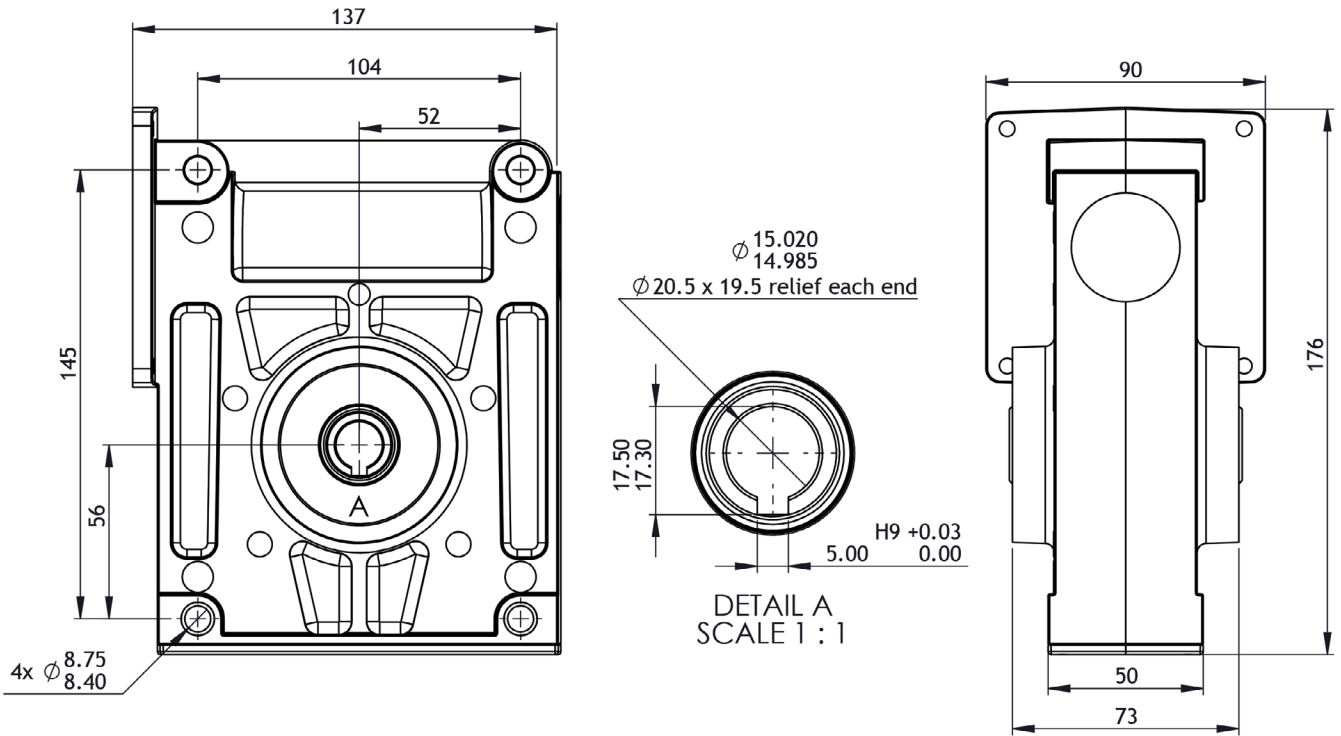

Part number key

Modular	#####
Standard	#####
Special	#####

Technical data

1 Part number		GB9-12.5C	735894	GB9-25C	735895	GB9-40C	735896	GB9-75C
2 Gear ratio	:1	12.5	15	25	30	40	60	75
3 Stages		1	1	1	1	1	1	1
4 Max. continuous torque (S1)	Nm	50.0	50.0	50.0	50.0	50.0	50.0	40.0
5 Max. intermittent torque (S3)	Nm	80.0	80.0	80.0	80.0	80.0	80.0	70.0
6 Efficiency	%	90	85	80	75	70	65	50
7 Backlash	arc.min	10-25	10-25	10-25	10-25	10-25	10-25	10-25
8 Max. axial load (dynamic)	N	600	600	600	600	600	600	600
9 Max. radial load, 12 mm from flange	N	800	800	800	800	800	800	800
10 Weight	kg	2.3	2.3	2.3	2.3	2.3	2.3	2.3
11 Gear material		Composite	Composite	Composite	Composite	Composite	Composite	Composite

* S1 & S3 duty cycles based on 3000 RPM input speed

Modular system



+L mm = added length